

2005-08 ACCESSORIES AND EQUIPMENT

Power Mirrors - RL

COMPONENT LOCATION INDEX

For the power mirror,
refer to the Driving Position Memory System (DPMS)

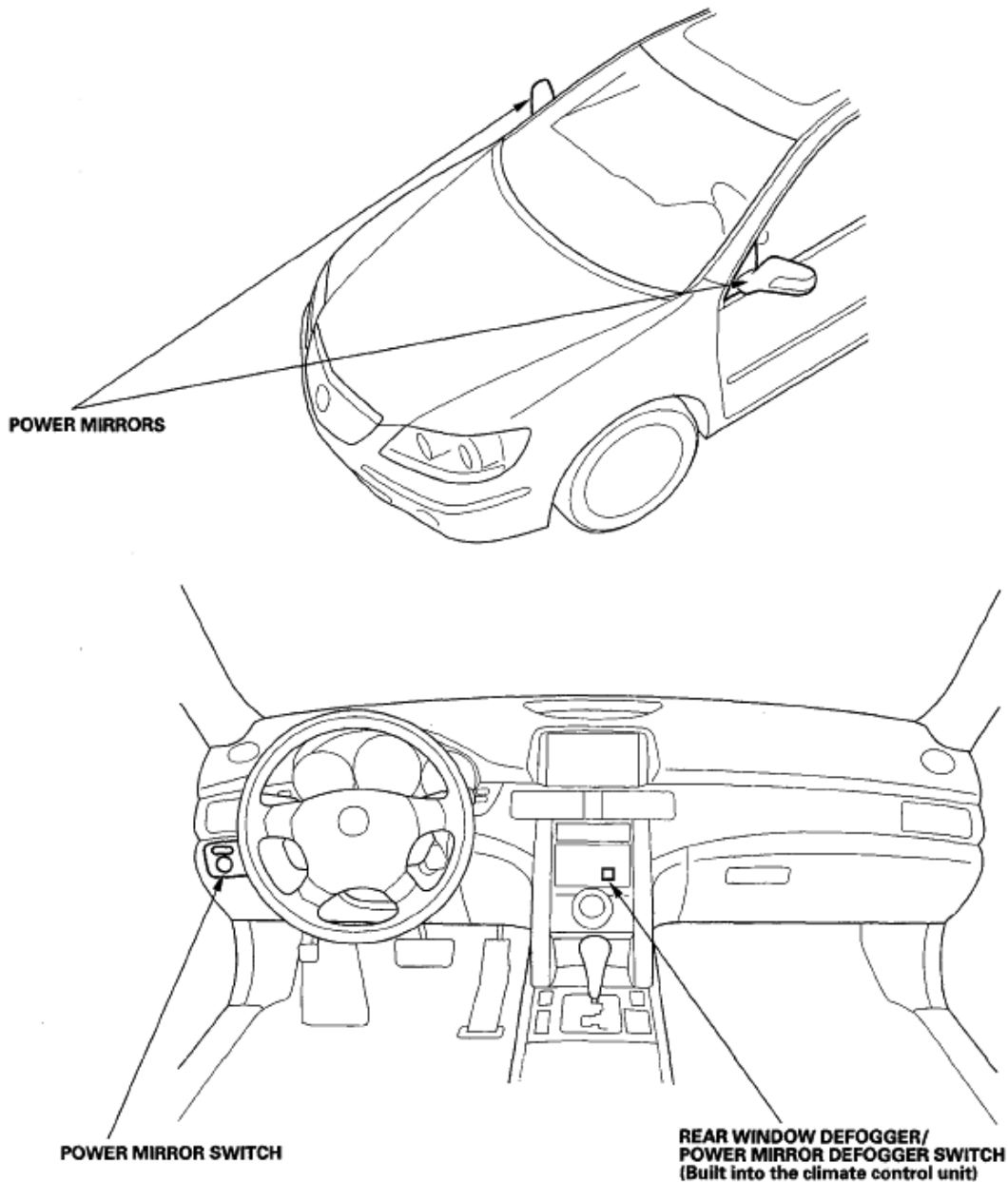

Fig. 1: Identifying Power Mirrors Component Location
Courtesy of AMERICAN HONDA MOTOR CO., INC.

POWER MIRROR SWITCH TEST/REPLACEMENT

1. Carefully pry the switch panel out from the dashboard.
2. Disconnect the 10P connector (A) from the power mirror switch (B).

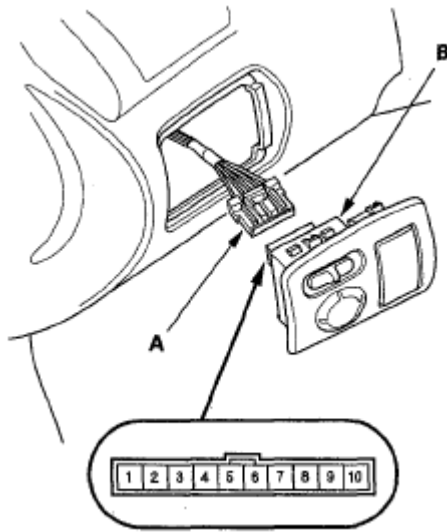

Fig. 2: Identifying Power Mirror Switch And 10P Connector
Courtesy of AMERICAN HONDA MOTOR CO., INC.

3. Check for continuity between the terminals in each switch position (see **Fig. 3**).

Mirror Switch:

| Terminal Position | 1 | 2 | 3 | 4 | 7 | 8 | 9 | 10 |
|-------------------|---|---|---|---|---|---|---|----|
| UP | | | | | ○ | — | — | ○ |
| DOWN | | | | ○ | — | — | — | ○ |
| LEFT | | | | | | ○ | — | ○ |
| RIGHT | | | ○ | — | — | — | — | ○ |
| L | | ○ | — | — | — | — | — | ○ |
| R | ○ | — | — | — | — | — | — | ○ |

Fig. 3: Checking For Continuity Between Terminals In Each Switch Position - Mirror Switch
Courtesy of AMERICAN HONDA MOTOR CO., INC.

4. If the continuity is not as specified, replace the power mirror switch.

POWER MIRROR ACTUATOR TEST

NOTE: The power mirror actuator can be tested by using the HDS and following these steps:

- Select **BODY ELECTRICAL** from the **SYSTEM SELECT** menu.
- Select **FUNCTION TEST**, and then the appropriate power mirror function test.

1. Remove the door panel (see **FRONT DOOR PANEL REMOVAL/INSTALLATION**).
2. Disconnect the 16P connector (A) from the power mirror actuator (B).

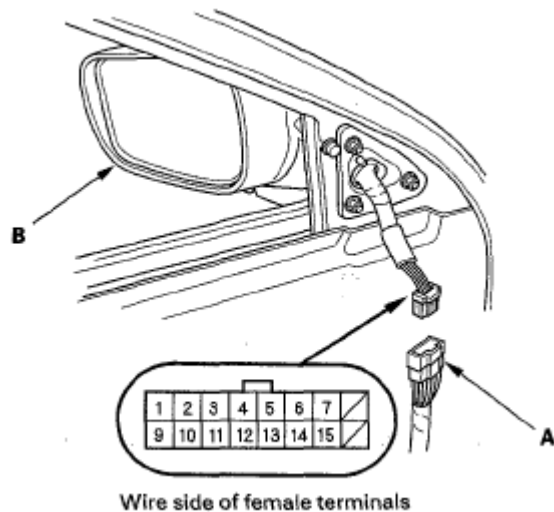

Fig. 4: Identifying Power Mirror Actuator And 16P Connector
 Courtesy of AMERICAN HONDA MOTOR CO., INC.

3. Check actuator operation by connecting power and ground (see **Fig. 5**).

| Terminal | 5 | 6 | 7 |
|--------------------|---|---|---|
| Position | | | |
| TILT UP | | ⊖ | ⊕ |
| TILT DOWN | | ⊕ | ⊖ |
| SWING LEFT | ⊖ | ⊕ | |
| SWING RIGHT | ⊕ | ⊖ | |

Fig. 5: Checking For Continuity Between Terminals In Each Switch Position
 Courtesy of AMERICAN HONDA MOTOR CO., INC.

4. If the mirror fails to work properly, replace the mirror actuator.

Defogger Test

5. Check the resistance between the No. 15 and No. 14 terminals of the 16P connector. There should be about 8 ohms or less.
 - If the resistance is not as specified, check for an open circuit.
 - If there is no open circuit and the harness is OK, replace the power mirror actuator (see **POWER MIRROR ACTUATOR REPLACEMENT**).

POWER MIRROR ACTUATOR REPLACEMENT

Removal

1. Remove the mirror holder (see **POWER MIRROR REPLACEMENT**), the power mirror (see **POWER MIRROR REPLACEMENT**), and disconnect the power mirror 16P connector.
2. Record the 16P connector terminal location and wire harness color.
3. Disassemble the power mirror 16P connector (A), and remove the terminals from it.

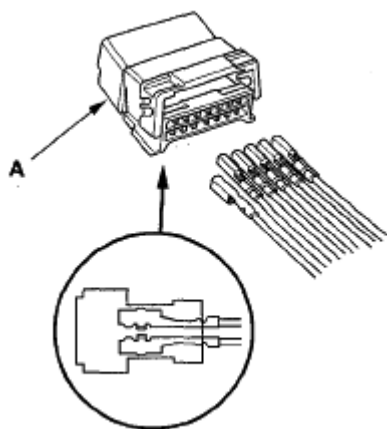

Fig. 6: Identifying Power Mirror 16P Connector
Courtesy of AMERICAN HONDA MOTOR CO., INC.

4. Remove the gasket (A), then remove the screw and clip (B).

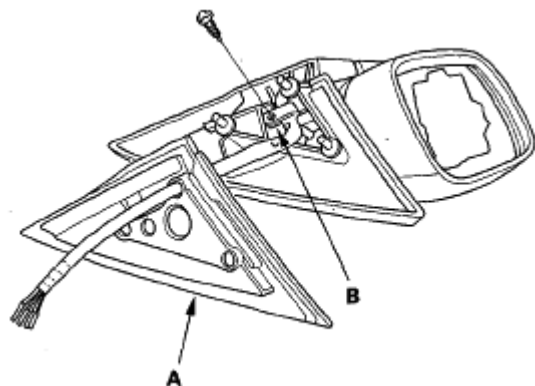

Fig. 7: Identifying Gasket, Screw And Clip
Courtesy of AMERICAN HONDA MOTOR CO., INC.

5. Remove the three TORX screws, and separate the mirror housing (A) from the bracket (B).

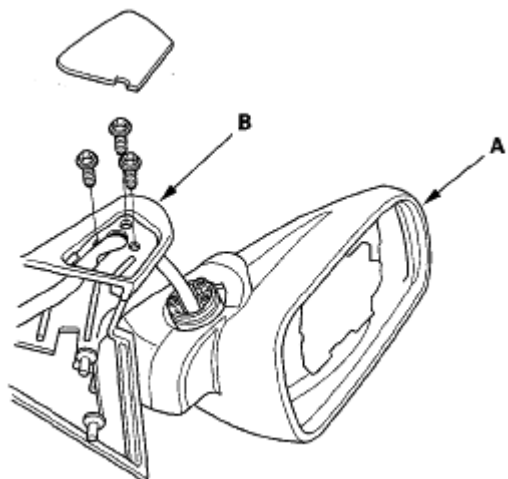

Fig. 8: Identifying Mirror Housing, Bracket And Torx Screws
Courtesy of AMERICAN HONDA MOTOR CO., INC.

6. Remove the screws and separate the actuator (A) from the housing (B), then disconnect the side turn signal light 2P connector (C).

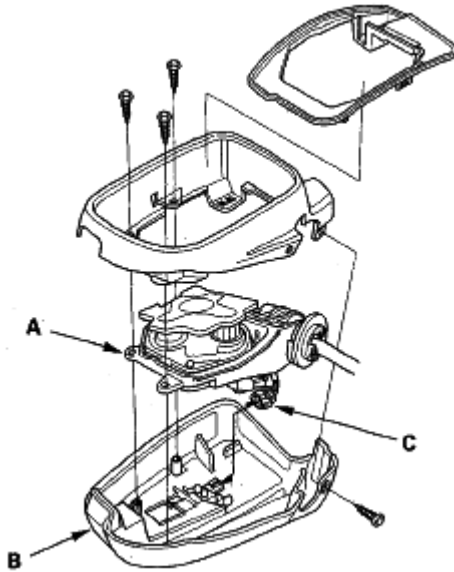

Fig. 9: Identifying Side Turn Signal Light 2P Connector And Housing
Courtesy of AMERICAN HONDA MOTOR CO., INC.

7. Remove the three screws and power mirror actuator (A).

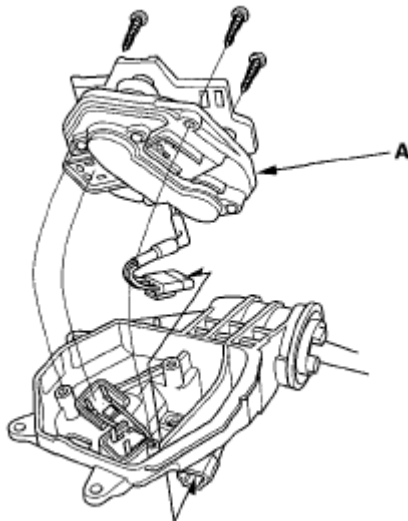

Fig. 10: Identifying Power Mirror Actuator And Screws
Courtesy of AMERICAN HONDA MOTOR CO., INC.

Installation

8. Route the wire harness of the new actuator through the hole in the bracket and gasket.
9. Install the actuator, bracket, harness clip, and gasket in the reverse order of removal.
10. Install the new actuator terminals into the connector in the original arrangement as shown.

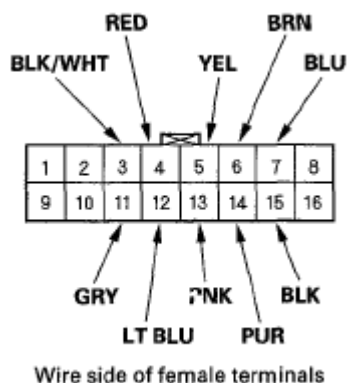

Fig. 11: Identifying Actuator Connector Terminals
Courtesy of AMERICAN HONDA MOTOR CO., INC.

11. Reassemble in the reverse order of disassembly. Be careful not to break the mirror holder when reinstalling it to the actuator.
12. Reinstall the mirror assembly to the door.
13. Operate the power mirror to ensure smooth operation.